

BEARING-Bearing LTD.

950 mm x 1250 mm x 400 mm ISO GE950DO
plain bearings

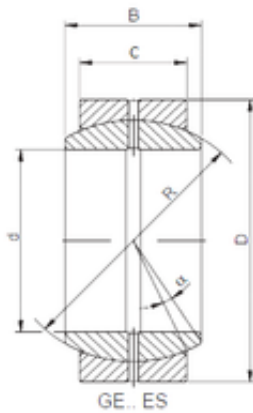

Bearing No. GE950DO

Size	950x1250x400 mm
Bore Diameter	950 mm
Outer Diameter	1250 mm
Width	400 mm
d	950 mm
D	1250 mm
B	400 mm
C	340 mm
R	1100 mm
Angle	3,3 °

GE950DO Bearing 2D drawings and 3D CAD models